



# Swapna Srushti Horizon Pvt. Ltd.

(Flagship Company of Sheth Construction Group)

Inquiry Offi. : B-30, Pramukh Arched, Reliance Chowkadi, Kudasani road, **Gandhinagar.**

Corp. Offi. : 160, Madhav Darshan, Waghavadi Road, **Bhavnagar.** 364001.

Vapi Offi. : 10, Pruthvi Corner, Above Mahindra Show Room, N.H.8, Balitha, **Vapi.** 396191.

Contact : +91 9727707944, 9979852031. Fax : 0278 2427461.



Email : [shethconstructiongroup@gmail.com](mailto:shethconstructiongroup@gmail.com),

Visit us on : [www.shethgroup1992.com](http://www.shethgroup1992.com)

**SELAN ECO FAST TOILET**

AN AFFORDABLE TOILET SOLUTION





# Swapna Srushti Horizon Pvt. Ltd.

(Flagship Company of Sheth Construction Group)

Inquiry Offi. : B-30, Pramukh Arched, Reliance Chowkadi, Kudasan road, **Gandhinagar.**

Corp. Offi. : 160, Madhav Darshan, Waghavadi Road, **Bhavnagar.** 364001.

Vapi Offi. : 10, Pruthvi Corner, Above Mahindra Show Room, N.H.8, Balitha, **Vapi.** 396191.

Contact : +91 9727707944, 9979852031. Fax : 0278 2427461.

## INDEX

1. Product Innovation Details
2. Brief Detail of Company
3. PreStressed PreCast RCC Technology Brief
4. Detail of SELAN Eco Fast Toilet Details
5. Drawing of Different Elements of Toilet
6. Drawing of Soak Pit For Toilet
7. Benefit of SELAN Eco Fast Toilet with SPED
8. Full Unit Photographs
9. Unique Features of SELAN Eco Fast Toilet with SPED
10. Comparison between different Pre-Fabricated Toilet with SELAN
11. Plant Photographs



Email : [shethconstructiongroup@gmail.com](mailto:shethconstructiongroup@gmail.com),

Visit us on : [www.shethgroup1992.com](http://www.shethgroup1992.com)

**SELAN ECO FAST TOILET**

AN AFFORDABLE TOILET SOLUTION





# Swapna Srushti Horizon Pvt. Ltd.

(Flagship Company of Sheth Construction Group)

Inquiry Offi. : B-30, Pramukh Arched, Reliance Chowkadi, Kudasana road, **Gandhinagar.**  
Corp. Offi. : 160, Madhav Darshan, Waghavadi Road, **Bhavnagar.** 364001.  
Vapi Offi. : 10, Pruthvi Corner, Above Mahindra Show Room, N.H.8, Balitha, **Vapi.** 396191.  
Contact : +91 9727707944, 9979852031. Fax : 0278 2427461.

## Product Innovation Details

If we look in to flashback we can see that 'father of Nation Mahatma Gandhi was the first leader who insisted on clean India movement in 1919.

Now, our present Prime Minister, Shri Narendra Modi has taken up the challenge, to give clean India and sanitation to all, by the year 2019.

As a part of the Social Duty, a Team of Technocrats have Joined the Mission Clean India, with the name of Team Selan. This Team has Developed an appropriate solution to cater the sanitation problem in India.

An Creative idea to provide innovative design for Sanitary requirement to each individual in India.

Design and material used for construction should be economical, durable, eco friendly, conventional, easy to execute, mass quantity production, acceptable in urban and rural area, and many more challenges came a cross.

We analyzed number of designs and material with respect to time required, quality required and workmen ship required for the construction of single unit as well as multiple unit construction.

Use of fly ash and other eco friendly material was also a concern towards the design and material used. Over and above the toilet unit should be durable having good quality, it should require least technical man power in remote area with limited sources.

To provide maximum toilet units in least time our technical and design team decided that modular design of easy to handle, transport and execute modules should be used.

Basic unit proposed are wall partitions, door, water tank, water supply, commode assembly, drain out systems and soak pit.

Technology of PreStressed concrete is used in mass quantity production. Support was also taken from PreStressed manufacturers of different members. A conclusion towards unique toilet design was established.



Email : [shethconstructiongroup@gmail.com](mailto:shethconstructiongroup@gmail.com),

Visit us on : [www.shethgroup1992.com](http://www.shethgroup1992.com)

**SELAN ECO FAST TOILET**

AN AFFORDABLE TOILET SOLUTION





# Swapna Srushti Horizon Pvt. Ltd.

(Flagship Company of Sheth Construction Group)

Inquiry Offi. : B-30, Pramukh Arched, Reliance Chowkadi, Kudasani road, **Gandhinagar.**

Corp. Offi. : 160, Madhav Darshan, Waghavadi Road, **Bhavnagar.** 364001.

Vapi Offi. : 10, Pruthvi Corner, Above Mahindra Show Room, N.H.8, Balitha, **Vapi.** 396191.

Contact : +91 9727707944, 9979852031. Fax : 0278 2427461.

## Brief Detail of Company

Swapna Srushti Horizon Pvt. Ltd. is a Flagship Company of Sheth Construction Group. Sheth Construction Group is well known in Saurashtra Region of Gujarat State. The Group is established in Year 1992.

We have a concrete experience of 23 Years in the field of Real Estate Development. The Group is having 2 Industries, who produce RCC PreStressed Concrete Transmission Poles for Electricity Board since last 15 Years. So, we have concrete experience of RCC PreStressed Concrete Product also.

The Group has completed 19 Residential Projects in different four Cities of Gujarat; namely Bhavnagar, Vapi, Ankleshwar and Palitana. We have given shelter to more than 2600 families on more than 35 Lacs Sq. Ft. Land. We are serving to Middle Income Group Families only with Affordable Township since inception of our Group. So, we are quite aware for making Affordable Product for LIG & MIG families.

When, our present Prime Minister, Shri Narendra Modi has taken up the challenge, to give clean India and sanitation to all, by the year 2019. Our Group has decided to join her hand for this noble social cause driven by our Prime Minister.

Our Group has built up a Team of Technocrat for Affordable Solution of Toilet for EWS & LIG families. The SELAN Eco Fast Toilet is the outcome of their continuous effort of 6 month.



Email : [shethconstructiongroup@gmail.com](mailto:shethconstructiongroup@gmail.com),

Visit us on : [www.shethgroup1992.com](http://www.shethgroup1992.com)

**SELAN ECO FAST TOILET**

AN AFFORDABLE TOILET SOLUTION





# Swapna Srushti Horizon Pvt. Ltd.

(Flagship Company of Sheth Construction Group)

Inquiry Offi. : B-30, Pramukh Arched, Reliance Chowkadi, Kudasana road, **Gandhinagar**.  
Corp. Offi. : 160, Madhav Darshan, Waghavadi Road, **Bhavnagar**. 364001.  
Vapi Offi. : 10, Pruthvi Corner, Above Mahindra Show Room, N.H.8, Balitha, **Vapi**. 396191.  
Contact : +91 9727707944, 9979852031. Fax : 0278 2427461.

## PreStressed PreCast RCC Technology Brief

We have used PreStressed Concrete Technology for SELAN ECO FAST TOILET.

### What is PreStressed Concrete Technology?

PreStressed Concrete element is different from conventional reinforced concrete element, due to the application of an initial load on the element prior to its use.



### Other uses of PreStressed Technology :

PreStressed concrete, is used in heavy beams, in bridges, electric pole manufacturing, railway sleepers



### Benefits of PreStressed Concrete Technology :

The technology offers speed, quality, and value at the same time.

The use of such technology, helps in saving up to 60% of the total man hours needed, in comparison of conventional methods. And it saves 50 % material also.



Email : [shethconstructiongroup@gmail.com](mailto:shethconstructiongroup@gmail.com),

Visit us on : [www.shethgroup1992.com](http://www.shethgroup1992.com)

**SELAN ECO FAST TOILET**

AN AFFORDABLE TOILET SOLUTION





# Swapna Srushti Horizon Pvt. Ltd.

(Flagship Company of Sheth Construction Group)

Inquiry Offi. : B-30, Pramukh Arched, Reliance Chowkadi, Kudasan road, **Gandhinagar.**  
Corp. Offi. : 160, Madhav Darshan, Waghavadi Road, **Bhavnagar.** 364001.  
Vapi Offi. : 10, Pruthvi Corner, Above Mahindra Show Room, N.H.8, Balitha, **Vapi.** 396191.  
Contact : +91 9727707944, 9979852031. Fax : 0278 2427461.

## Detail of SELAN Eco Fast Toilet Details

**Base Unit :** The Base Unit Is Made Of Aerated Concrete Blocks, Having Half The Strength Of Concrete. The First Layer Has 4 Members, Which Includes Step. The Members Of The Second Layer Support The Comode, And Help In Fixing Assembly.

**Base Tie :** This Is Main Fabricated Element, Which Tie Up Whole Unit at Bottom Level. This is from metal.

**Corner Column :** The Main Backbone Of The Toilet Are Corner Column. These Are PreStressed Concrete Column, Having A Dimension Of 9cm X 9cm. The Column Have Groves, So Designed That The Wall Panel Fits Into It.

**Wall Panel :** The Wall Panel Are Made Of, PreStressed Concrete, Having 2.5 Cm thickness. These Panels Have A, Unique Tong Grove Type Design, This Helps In Keeping Privacy In The Toilet.

**Top Cross Tie :** This Is Top Main Fabricated Element, Which Tie Up Whole Unit at Top Level. This is from metal.

**Top Supportive Slab :** This Is Top Supportive Slab From Aerated Concrete. It Also Support Water Tank And Protect From Rain Also.

**Door :** The Door Is Flush Door with Oil Paint applied.

### 2 Type of SELAN Toilet :

\*\* Toilet Without Water Tank

\*\* Toilet With Water Tank

Technical Details of Single Unit of Selan Eco Fast Toilet	
Inside Clear size	90 Cm. x 90 Cm.
Out Side Size	106 Cm. x 106 Cm.
Out Side Dimension With Step	130 Cm. x 106 Cm.
Inside Clear Height of Unit	195 Cm.
Height of Steps	30 Cm.
Height of Tank	60 Cm.
Storage Capacity of Tank	200 Lt.
ટોઈલેટ-ની કુલ ઉચાઈ	8' 0"
કુલ વજન	450



Email : [shethconstructiongroup@gmail.com](mailto:shethconstructiongroup@gmail.com),

Visit us on : [www.shethgroup1992.com](http://www.shethgroup1992.com)

**SELAN ECO FAST TOILET**

AN AFFORDABLE TOILET SOLUTION





# Swapna Srushti Horizon Pvt. Ltd.

(Flagship Company of Sheth Construction Group)

Inquiry Offi. : B-30, Pramukh Arched, Reliance Chowkadi, Kudasana road, **Gandhinagar.**

Corp. Offi. : 160, Madhav Darshan, Waghavadi Road, **Bhavnagar.** 364001.

Vapi Offi. : 10, Pruthvi Corner, Above Mahindra Show Room, N.H.8, Balitha, **Vapi.** 396191.

Contact : +91 9727707944, 9979852031. Fax : 0278 2427461.

## Drawing of Different Elements of Toilet

### Main RCC PreStressed Concrete Panels Drawing

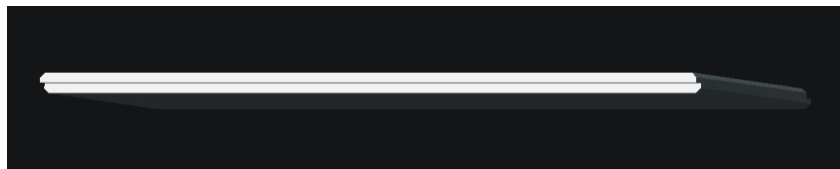
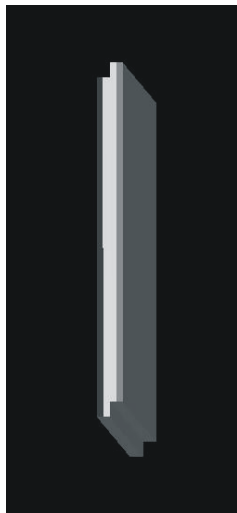
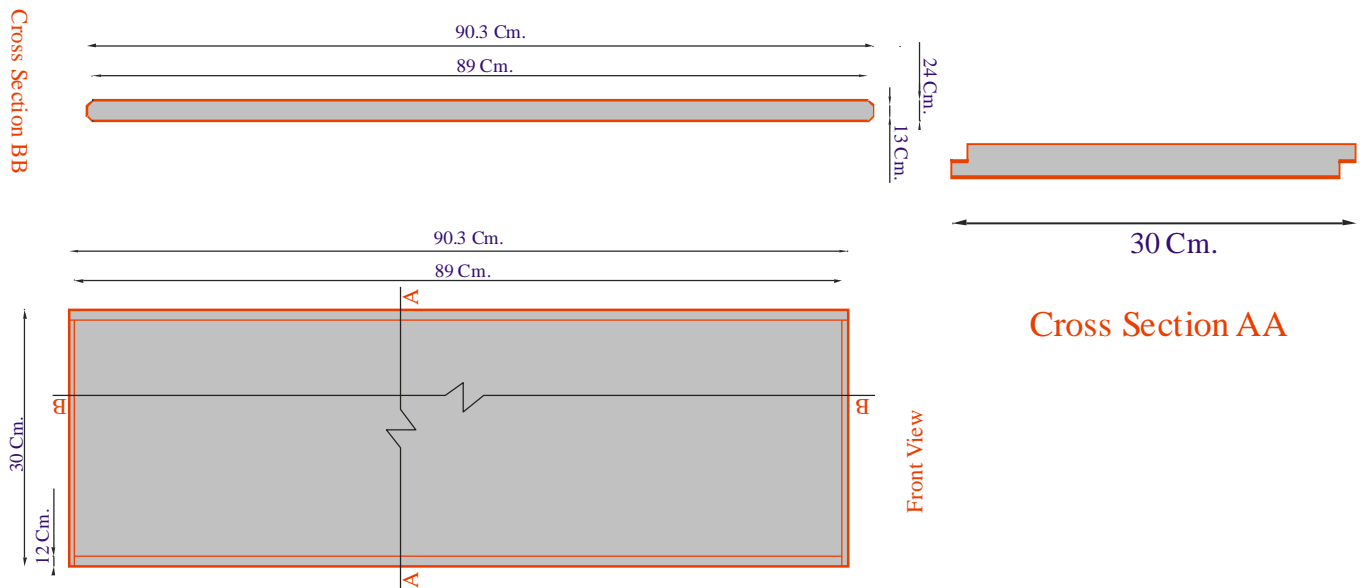

Email : [shethconstructiongroup@gmail.com](mailto:shethconstructiongroup@gmail.com),

Visit us on : [www.shethgroup1992.com](http://www.shethgroup1992.com)

**SELAN ECO FAST TOILET**

AN AFFORDABLE TOILET SOLUTION





# Swapna Srushti Horizon Pvt. Ltd.

(Flagship Company of Sheth Construction Group)

Inquiry Offi. : B-30, Pramukh Arched, Reliance Chowkadi, Kudasan road, **Gandhinagar.**  
 Corp. Offi. : 160, Madhav Darshan, Waghavadi Road, **Bhavnagar.** 364001.  
 Vapi Offi. : 10, Pruthvi Corner, Above Mahindra Show Room, N.H.8, Balitha, **Vapi.** 396191.  
 Contact : +91 9727707944, 9979852031. Fax : 0278 2427461.

## Drawing of Different Elements of Toilet

### Main RCC PreStressed Concrete Column Drawing

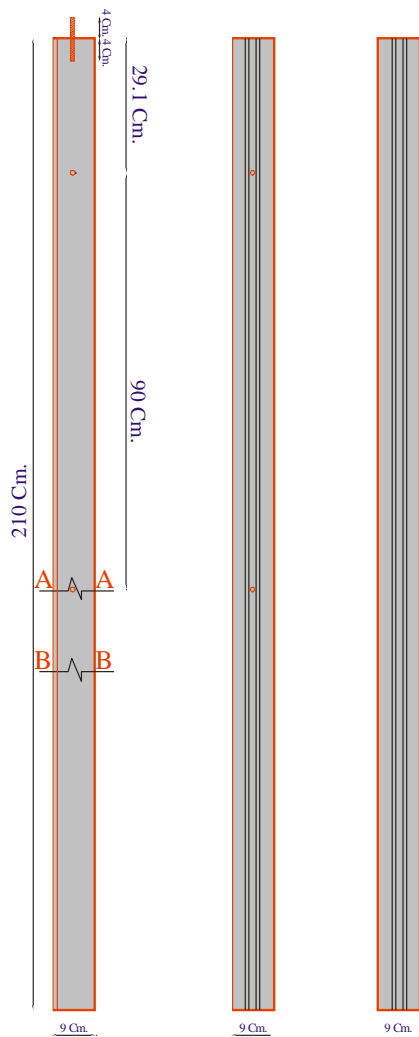

Front View

Back View

Cross View

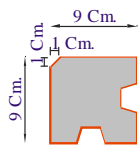

Cross Section BB

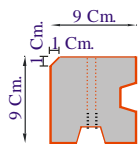

Cross Section AA



Top View

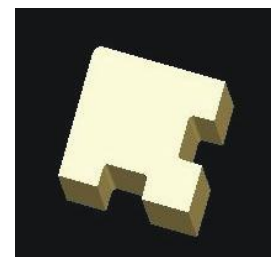

Bottom View



Email : [shethconstructiongroup@gmail.com](mailto:shethconstructiongroup@gmail.com),

Visit us on : [www.shethgroup1992.com](http://www.shethgroup1992.com)

**SELAN ECO FAST TOILET**

AN AFFORDABLE TOILET SOLUTION







# Swapna Srushti Horizon Pvt. Ltd.

(Flagship Company of Sheth Construction Group)

Inquiry Offi. : B-30, Pramukh Arched, Reliance Chowkadi, Kudasan road, **Gandhinagar.**

Corp. Offi. : 160, Madhav Darshan, Waghavadi Road, **Bhavnagar.** 364001.

Vapi Offi. : 10, Pruthvi Corner, Above Mahindra Show Room, N.H.8, Balitha, **Vapi.** 396191.

Contact : +91 9727707944, 9979852031. Fax : 0278 2427461.

## Drawing of Soak Pit For Toilet

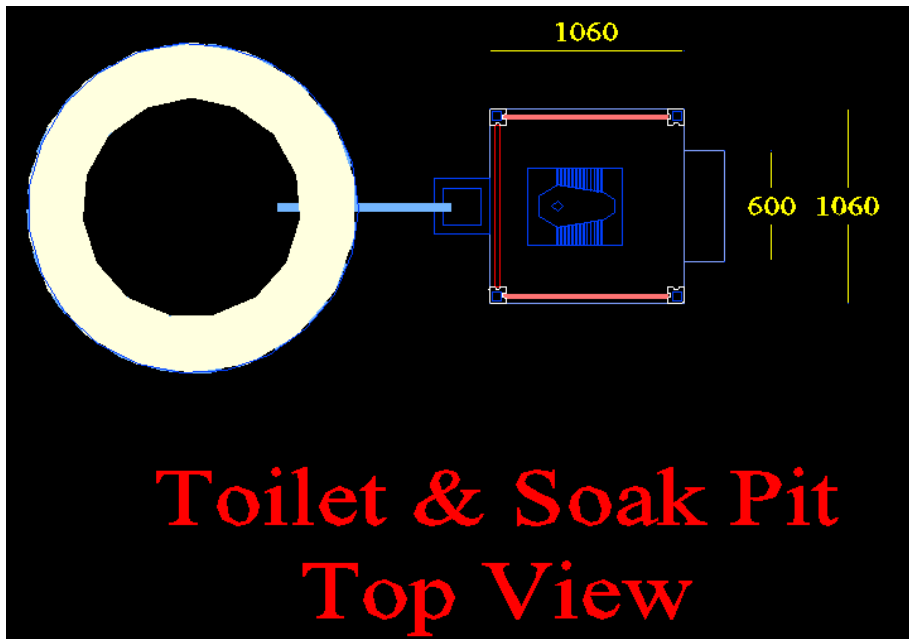

Email : [shethconstructiongroup@gmail.com](mailto:shethconstructiongroup@gmail.com),

Visit us on : [www.shethgroup1992.com](http://www.shethgroup1992.com)

**SELAN ECO FAST TOILET**

AN AFFORDABLE TOILET SOLUTION





# Swapna Srushti Horizon Pvt. Ltd.

(Flagship Company of Sheth Construction Group)

Inquiry Offi. : B-30, Pramukh Arched, Reliance Chowkadi, Kudasana road, **Gandhinagar.**

Corp. Offi. : 160, Madhav Darshan, Waghavadi Road, **Bhavnagar.** 364001.

Vapi Offi. : 10, Pruthvi Corner, Above Mahindra Show Room, N.H.8, Balitha, **Vapi.** 396191.

Contact : +91 9727707944, 9979852031. Fax : 0278 2427461.

## Benefit of SELAN Eco Fast Toilet with SPED

- 1. Selan Eco Fast Toilet can be Installed within 55 Min. It is A Great Achievement of The Selan Team.**
- 2. Design is Conventional and Acceptable to Everyone, For Their Primary Use.**
- 3. Material Used is Familiar to User,**
- 4. It Provides Conventional Look and Possesses, Much More Superior Quality, Then Current Available Options.**
- 5. Resource Utilization is Very Less At Users End.**
- 6. Easy Execution of Toilet, with Minimum Time, Helps in Achieving Desired Targets.**
- 7. Absolutely No Skill Workforce Required at the Execution, Makes it The Best Option.**
- 8. The Toilet Unit, has Pre Check Modules For Dimensions And Quality This Makes It, A Durable Product.**
- 9. Due to Prestressed Technology, Selan Eco Fast Toilet will be Maintenance Free and having Long Life, that Makes Selan Eco Fast a Unique Toilet.**



Email : [shethconstructiongroup@gmail.com](mailto:shethconstructiongroup@gmail.com),

Visit us on : [www.shethgroup1992.com](http://www.shethgroup1992.com)

**SELAN ECO FAST TOILET**

AN AFFORDABLE TOILET SOLUTION





# Swapna Srushti Horizon Pvt. Ltd.

(Flagship Company of Sheth Construction Group)

Inquiry Offi. : B-30, Pramukh Arched, Reliance Chowkadi, Kudas an road, **Gandhinagar.**

Corp. Offi. : 160, Madhav Darshan, Waghavadi Road, **Bhavnagar.** 364001.

Vapi Offi. : 10, Pruthvi Corner, Above Mahindra Show Room, N.H.8, Balitha, **Vapi.** 396191.

Contact : +91 9727707944, 9979852031. Fax : 0278 2427461.

## Full Unit Photographs



2.15 mt.

1.06 mt.

1.06 mt.



Email : [shethconstructiongroup@gmail.com](mailto:shethconstructiongroup@gmail.com),

Visit us on : [www.shethgroup1992.com](http://www.shethgroup1992.com)

**SELAN ECO FAST TOILET**

AN AFFORDABLE TOILET SOLUTION





# Swapna Srushti Horizon Pvt. Ltd.

(Flagship Company of Sheth Construction Group)

Inquiry Offi. : B-30, Pramukh Arched, Reliance Chowkadi, Kudasana road, **Gandhinagar.**

Corp. Offi. : 160, Madhav Darshan, Waghavadi Road, **Bhavnagar.** 364001.

Vapi Offi. : 10, Pruthvi Corner, Above Mahindra Show Room, N.H.8, Balitha, **Vapi.** 396191.

Contact : +91 9727707944, 9979852031. Fax : 0278 2427461.

## Unique Features of SELAN Eco Fast Toilet with SPED

- Ready to Install Toilet first of its kind for Common man Life Long use.
- Design is conventional and acceptable to everyone and all for their primary use.
- Material used is traditional construction material. Material used is familiar to user, it provides conventional look and possesses much more superior quality than current available options.
- No Skilled Labour will be required to install the unit. No Raw material will be required to carry to install the toilet. No machinery or equipment will be required to install the toilet. Means, Resource utilization very less at users end. Hence the unit is quite unique in Toilet design.
- The energy consumption is less as the gross amount of material consumption is less.
- Fly ash utilization in making of Aerated products makes it eco friendly.
- Easy execution of toilet with minimum time. It will help to achieve desired targets of Toilet installation. 2 Person can install 10 Toilet Per Day.
- Absolutely no skill work force required at the execution end, makes it the best option.
- Mass Quantity available with assured consistent quality makes it an unique product.
- The design of product is acceptable in urban and rural area, as produce by natural concrete product.
- The toilet unit has pre check modules for dimensions and quality this makes it a durable product and can be used for life long and for all weather condition.



Email : [shethconstructiongroup@gmail.com](mailto:shethconstructiongroup@gmail.com),

Visit us on : [www.shethgroup1992.com](http://www.shethgroup1992.com)

**SELAN ECO FAST TOILET**

AN AFFORDABLE TOILET SOLUTION





# Swapna Srushti Horizon Pvt. Ltd.

(Flagship Company of Sheth Construction Group)

Inquiry Offi. : B-30, Pramukh Arched, Reliance Chowkadi, Kudasani road, **Gandhinagar**.  
Corp. Offi. : 160, Madhav Darshan, Waghavadi Road, **Bhavnagar**. 364001.  
Vapi Offi. : 10, Pruthvi Corner, Above Mahindra Show Room, N.H.8, Balitha, **Vapi**. 396191.  
Contact : +91 9727707944, 9979852031. Fax : 0278 2427461.

- The toilet unit has pre check modules for dimensions and quality this makes it a durable product and can be used for life long and for all weather condition.
- As checking is completed at the vendors end the end product does not require any technical supervision or third party inspection on site.
- Modular very light weight design (single person can lift any part of toilet) makes easy to transport and handle the product.
- Technology of PreCast & PreStress Concrete and Aerated Concrete is used to give good quality with mass production.
- \* Ready to Install Toilet means “Hassle Free Solution”.
- \* Ready to Install Toilet means “Easy to Erect & Ready to Use”.
- \* Ready to Install Toilet means “All Weather, Life Long Solution”.
- \* Ready to Install Toilet means “No Raw Material, No Skilled Labour”.
- \* Ready to Install Toilet means “Innovative Environment Friendly”.
- \* Ready to Install Toilet means “One Hour, Ready to Install Capability”.
- \* Ready to Install Toilet means “Life Long, Maintenance Free”.
- \* Ready to Install Toilet means “Decent & Conventional Appearance”.



Email : [shethconstructiongroup@gmail.com](mailto:shethconstructiongroup@gmail.com),

Visit us on : [www.shethgroup1992.com](http://www.shethgroup1992.com)

**SELAN ECO FAST TOILET**

AN AFFORDABLE TOILET SOLUTION





# Swapna Srushti Horizon Pvt. Ltd.

(Flagship Company of Sheth Construction Group)

Inquiry Offi. : B-30, Pramukh Arched, Reliance Chowkadi, Kudasana road, **Gandhinagar.**

Corp. Offi. : 160, Madhav Darshan, Waghavadi Road, **Bhavnagar.** 364001.

Vapi Offi. : 10, Pruthvi Corner, Above Mahindra Show Room, N.H.8, Balitha, **Vapi.** 396191.

Contact : +91 9727707944, 9979852031. Fax : 0278 2427461.

## Comparison between different Pre-Fabricated Toilet with SELAN

### Traditional Toilet

Comparison	Selan Eco fast toilet Pre-Stressed Concrete	Traditional Toilet By Construction
<b>Material</b>	Consistent Quality with smallest size of section.	Consistent Quality of Material not Possible
<b>Strength</b>	Provides Best Strength with smaller and thinner sections.	Strength may vary from place to place and material to material and depend upon workmanship
<b>Execution Time</b>	Very less time required for execution (60 Min.).	Time required for execution is 4 Man Days
<b>Skilled Labour/</b>	Only 2 unskilled labour required.	More no of Skilled/ unskilled labour required.
<b>Technical Supervision</b>	No technical supervision required as elements are per checked and tested.	Technical Supervision required at every stage and phase to get good work.
<b>Maintenance</b>	Maintenance not required.	Difficult to maintain and cost of maintenance is more.
<b>Quality</b>	Best Quality. Manufactured in Factory.	may vary from material to material and depend upon workmanship
<b>Environment Friendliness</b>	Fully. Fly Ash is used for Manufacturing.	Partially
<b>Cost</b>	Most economical with respect to any other available product	Total cost of toilet varies with local raw material cost.
<b>NGO Point of View</b>	Best for NGO as easy to handle, execute with good quality.	Difficulty to handle material & quality assurance.
<b>Life</b>	Min. 10 Years.	If Properly Constructed than 10 Yrs.



Email : [shethconstructiongroup@gmail.com](mailto:shethconstructiongroup@gmail.com),

Visit us on : [www.shethgroup1992.com](http://www.shethgroup1992.com)

**SELAN ECO FAST TOILET**

AN AFFORDABLE TOILET SOLUTION





# Swapna Srushti Horizon Pvt. Ltd.

(Flagship Company of Sheth Construction Group)

Inquiry Offi. : B-30, Pramukh Arched, Reliance Chowkadi, Kudasana road, **Gandhinagar.**

Corp. Offi. : 160, Madhav Darshan, Waghavadi Road, **Bhavnagar.** 364001.

Vapi Offi. : 10, Pruthvi Corner, Above Mahindra Show Room, N.H.8, Balitha, **Vapi.** 396191.

Contact : +91 9727707944, 9979852031. Fax : 0278 2427461.

## Comparison between different Pre-Fabricated Toilet with SELAN

### PVC Pre-Fabricated Toilet

Comparison	Selan Eco fast toilet Pre-Stressed Concrete	PVC Toilet
<b>Material</b>	Consistent Quality with smallest size of section.	Consistent material but Brittle in Nature
<b>Strength</b>	Provides Best Strength with smaller and thinner sections.	With passage of time loses its strength. & Depend on Weather Conditions
<b>Execution Time</b>	Very less time required for execution (60 Min.).	Readymade so execution time not considered.
<b>Skilled Labour/</b>	Only 2 unskilled labour required.	More unskilled required for transits of toilet.
<b>Technical Supervision</b>	No technical supervision required as elements are per checked and tested.	Technical guidance required at the side of manufacture.
<b>Maintenance</b>	Maintenance not required.	Maintenance not possible.
<b>Quality</b>	Best Quality. Manufactured in Factory.	Consistent but with more cost
<b>Environment Friendliness</b>	Fully. Fly Ash is used for Manufacturing.	Not
<b>Cost</b>	Most economical with respect to any other available product	Very High
<b>NGO Point of View</b>	Best for NGO as easy to handle, execute with good quality.	Past experiences show that toilet have not performed well.
<b>Life</b>	Min. 10 Years.	1 to 2 Yrs., As Per Past Experience



Email : [shethconstructiongroup@gmail.com](mailto:shethconstructiongroup@gmail.com),

Visit us on : [www.shethgroup1992.com](http://www.shethgroup1992.com)

**SELAN ECO FAST TOILET**

AN AFFORDABLE TOILET SOLUTION





# Swapna Srushti Horizon Pvt. Ltd.

(Flagship Company of Sheth Construction Group)

Inquiry Offi. : B-30, Pramukh Arched, Reliance Chowkadi, Kudasana road, **Gandhinagar.**

Corp. Offi. : 160, Madhav Darshan, Waghavadi Road, **Bhavnagar.** 364001.

Vapi Offi. : 10, Pruthvi Corner, Above Mahindra Show Room, N.H.8, Balitha, **Vapi.** 396191.

Contact : +91 9727707944, 9979852031. Fax : 0278 2427461.

## Comparison between different Pre-Fabricated Toilet with SELAN

### Concrete Pre-Cast Pre-Fabricated Toilet

Comparison	Selan Eco fast toilet Pre-Stressed Concrete	Concrete Pre-Cast Toilet
<b>Material</b>	Consistent Quality with smallest size of section.	Heavy Section required for same strength
<b>Strength</b>	Provides Best Strength with smaller and thinner sections.	Strength not possible in smaller and thinner section.
<b>Execution Time</b>	Very less time required for execution (60 Min.).	Time required is less than traditional but more than Selan.
<b>Skilled Labour/</b>	Only 2 unskilled labour required.	More unskilled required due to heavy section.
<b>Technical Supervision</b>	No technical supervision required as elements are per checked and tested.	Technical supervision required as elements are very heavy and difficult to handle.
<b>Maintenance</b>	Maintenance not required.	Maintenance not possible.
<b>Quality</b>	Best Quality. Manufactured in Factory.	can be maintained but with very heavy section and difficult to handle.
<b>Environment Friendliness</b>	Fully. Fly Ash is used for Manufacturing.	Partially
<b>Cost</b>	Most economical with respect to any other available product	More cost as the section size is larger for similar product.
<b>NGO Point of View</b>	Best for NGO as easy to handle, execute with good quality.	Due to heavy weight difficult to handle and execute.
<b>Life</b>	Min. 10 Years.	About 5 Yrs., As Per Past Experience



Email : [shethconstructiongroup@gmail.com](mailto:shethconstructiongroup@gmail.com),

Visit us on : [www.shethgroup1992.com](http://www.shethgroup1992.com)

**SELAN ECO FAST TOILET**

AN AFFORDABLE TOILET SOLUTION







# Swapna Srushti Horizon Pvt. Ltd.

(Flagship Company of Sheth Construction Group)

Inquiry Offi. : B-30, Pramukh Arched, Reliance Chowkadi, Kudasana road, **Gandhinagar.**

Corp. Offi. : 160, Madhav Darshan, Waghavadi Road, **Bhavnagar.** 364001.

Vapi Offi. : 10, Pruthvi Corner, Above Mahindra Show Room, N.H.8, Balitha, **Vapi.** 396191.

Contact : +91 9727707944, 9979852031. Fax : 0278 2427461.

---

## REASONS :

1. As this is a RCC Product, So transportation cost is high.
2. We can easily manage labour force in above area.
3. Overhead expenses can be reduced and we can serve with cheaper rate.
4. PVC Readymade tank is difficult to handle at long distance.
5. We are aware of land terrain of the states.
6. We are capable to manage execution problems in the states.
7. We can serve with best speed and able to complete required targets.



---

Email : [shethconstructiongroup@gmail.com](mailto:shethconstructiongroup@gmail.com),

Visit us on : [www.shethgroup1992.com](http://www.shethgroup1992.com)

**SELAN ECO FAST TOILET**

AN AFFORDABLE TOILET SOLUTION





# Swapna Srushti Horizon Pvt. Ltd.

(Flagship Company of Sheth Construction Group)

Inquiry Offi. : B-30, Pramukh Arched, Reliance Chowkadi, Kudson road, **Gandhinagar.**

Corp. Offi. : 160, Madhav Darshan, Waghavadi Road, **Bhavnagar.** 364001.

Vapi Offi. : 10, Pruthvi Corner, Above Mahindra Show Room, N.H.8, Balitha, **Vapi.** 396191.

Contact : +91 9727707944, 9979852031. Fax : 0278 2427461.

## Production Plant Photographs



Email : [shethconstructiongroup@gmail.com](mailto:shethconstructiongroup@gmail.com),

Visit us on : [www.shethgroup1992.com](http://www.shethgroup1992.com)

**SELAN ECO FAST TOILET**

AN AFFORDABLE TOILET SOLUTION





# Swapna Srushti Horizon Pvt. Ltd.

(Flagship Company of Sheth Construction Group)

Inquiry Offi. : B-30, Pramukh Arched, Reliance Chowkadi, Kudasana road, **Gandhinagar.**

Corp. Offi. : 160, Madhav Darshan, Waghavadi Road, **Bhavnagar.** 364001.

Vapi Offi. : 10, Pruthvi Corner, Above Mahindra Show Room, N.H.8, Balitha, **Vapi.** 396191.

Contact : +91 9727707944, 9979852031. Fax : 0278 2427461.

## Production Plant Photographs



Email : [shethconstructiongroup@gmail.com](mailto:shethconstructiongroup@gmail.com),

Visit us on : [www.shethgroup1992.com](http://www.shethgroup1992.com)

**SELAN ECO FAST TOILET**

AN AFFORDABLE TOILET SOLUTION

